

CONTRACTOR SHALL CHECK ALL DIMENSIONS ON THE WORK AND REPORT ANY DISCREPANCY TO THE LANDSCAPE ARCHITECT BEFORE PROCEEDING. ALL DRAWINGS AND SPECIFICATIONS ARE THE PROPERTY OF THE LANDSCAPE ARCHITECT AND MUST BE RETURNED AT THE COMPLETION OF THE WORK. THIS DRAWING IS NOT TO BE USED FOR CONSTRUCTION UNTIL SIGNED BY THE LANDSCAPE ARCHITECT.

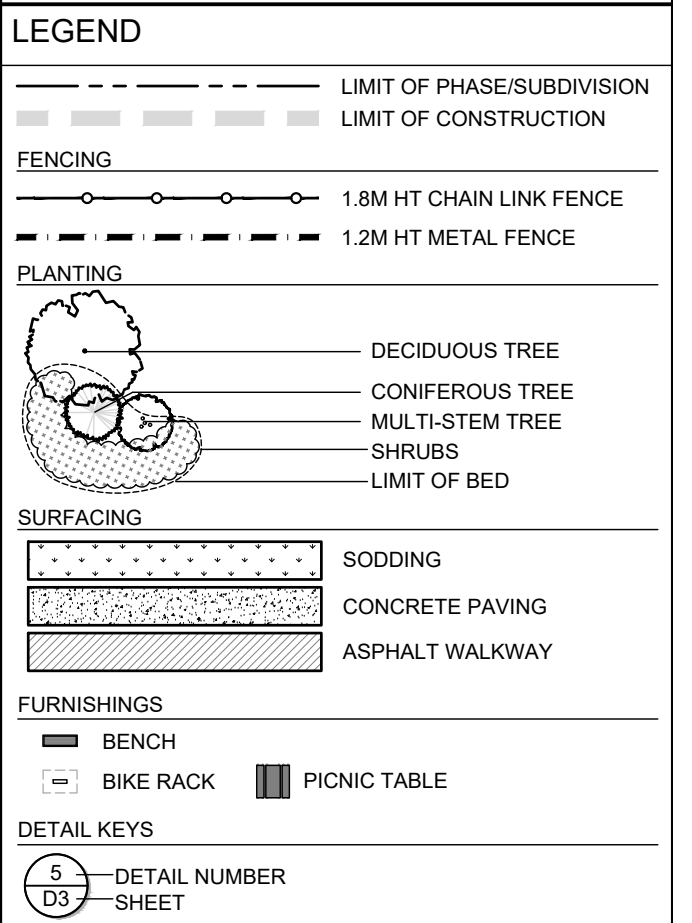

### REVISIONS

No.	Description	Date
1	Issued for 1st submission	Oct 06/23

### CITY APPROVAL STAMP

No. Description		Date

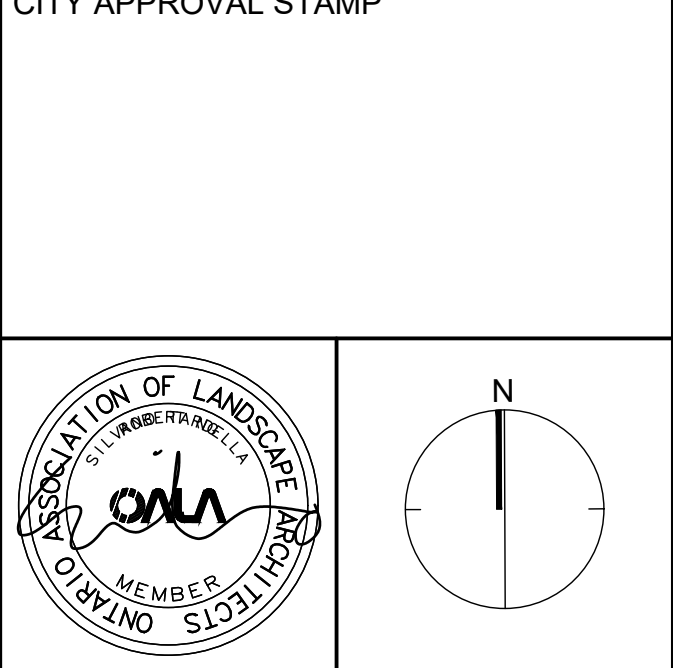

**NAK**  
design strategies

421 RONCESVALLES AVENUE, TORONTO, ON M6R 2N1 CANADA  
T 416.340.8700 F 416.340.7100 NAKDESIGNSTRATEGIES.COM

**PROJECT**  
MATTAMY WHITEVALE  
(PHASE 2) NORTH  
City of Pickering, Ontario

**OWNER**

**TITLE**  
LAYOUT & SURFACING  
PLAN

DATE: OCT 06/23 SHEET  
SCALE: 1:200  
DRAWN: MC  
CHECKED: MC  
JOB NO.: 23-130

P1

- ### NOTES:
- ALL AREAS DISTURBED DURING CONSTRUCTION, INCLUDING FUTURE BUILDING BLOCKS, SHALL BE FINE GRADED, COVERED WITH TOPSOIL AND SODDED UNLESS OTHERWISE NOTICED. DEVELOPER TO PERFORM REGULARLY SCHEDULED MAINTENANCE ON ALL UNDEVELOPED BLOCKS.
  - ALL OPEN SPACE BLOCKS, VALLEYLAND AND SWM BLOCKS SHALL BE MAINTAINED FREE OF GARBAGE AND CONSTRUCTION DEBRIS BY THE DEVELOPER UNTIL ASSUMPTION OF THE SUBDIVISION BY THE CITY OF PICKERING.
  - ALL BLOCKS THAT ARE UNDEVELOPED WITHIN THE SUBDIVISION ARE TO BE FINE GRADED, COVERED WITH TOPSOIL AND SODDED UNLESS OTHERWISE NOTICED. DEVELOPER TO PERFORM REGULARLY SCHEDULED MAINTENANCE ON ALL UNDEVELOPED BLOCKS.
  - ALL ARTERIAL ROADS BUFFER TUFF TO BE SODDED. SOD SHALL EXTEND TO CENTRE OF DITCH OR TO CURB AS APPLICABLE.
  - PARK AND OTHER OPEN SPACE BLOCKS ARE NOT TO BE USED FOR STORAGE OF TOPSOIL STOCKPILES, CONSTRUCTION MATERIAL OR CONSTRUCTION TRAILERS.
  - PLANTING SOIL (MECHANICALLY MIX) 6-PARTS SANDY LOAM, 2 PARTS WELL ROTTED MANURE, 1 PART PEAT MOSS
  - ALL BOULEVARDS ARE TO BE GRADED, COVERED WITH TOPSOIL AND SODDED TO CURB OR CENTER OF DITCH AS IS APPLICABLE. THIS INCLUDES ARTERIAL ROAD BOULEVARDS ADJACENT TO THE SUBJECT LANDS
  - REFER TO SHEET D01 FOR STANDARD STREETSCAPE NOTES
  - STREET TREE SET BACK CRITERIA: REFER TO STANDARD DRAWING NOTES ON D01
  - IN THE CASE OF A CONFLICT WITH UTILITIES, TREES MAY BE RELOCATED OR REMOVED WITHIN THE ROAD ALLOWANCE
  - THE CITY RESERVES THE RIGHT TO REMOVE OR ADD A STREET TREE DEPENDING ON SITE CONDITIONS

