

## **APPENDIX B: Vehicular Manoeuvring Diagrams**

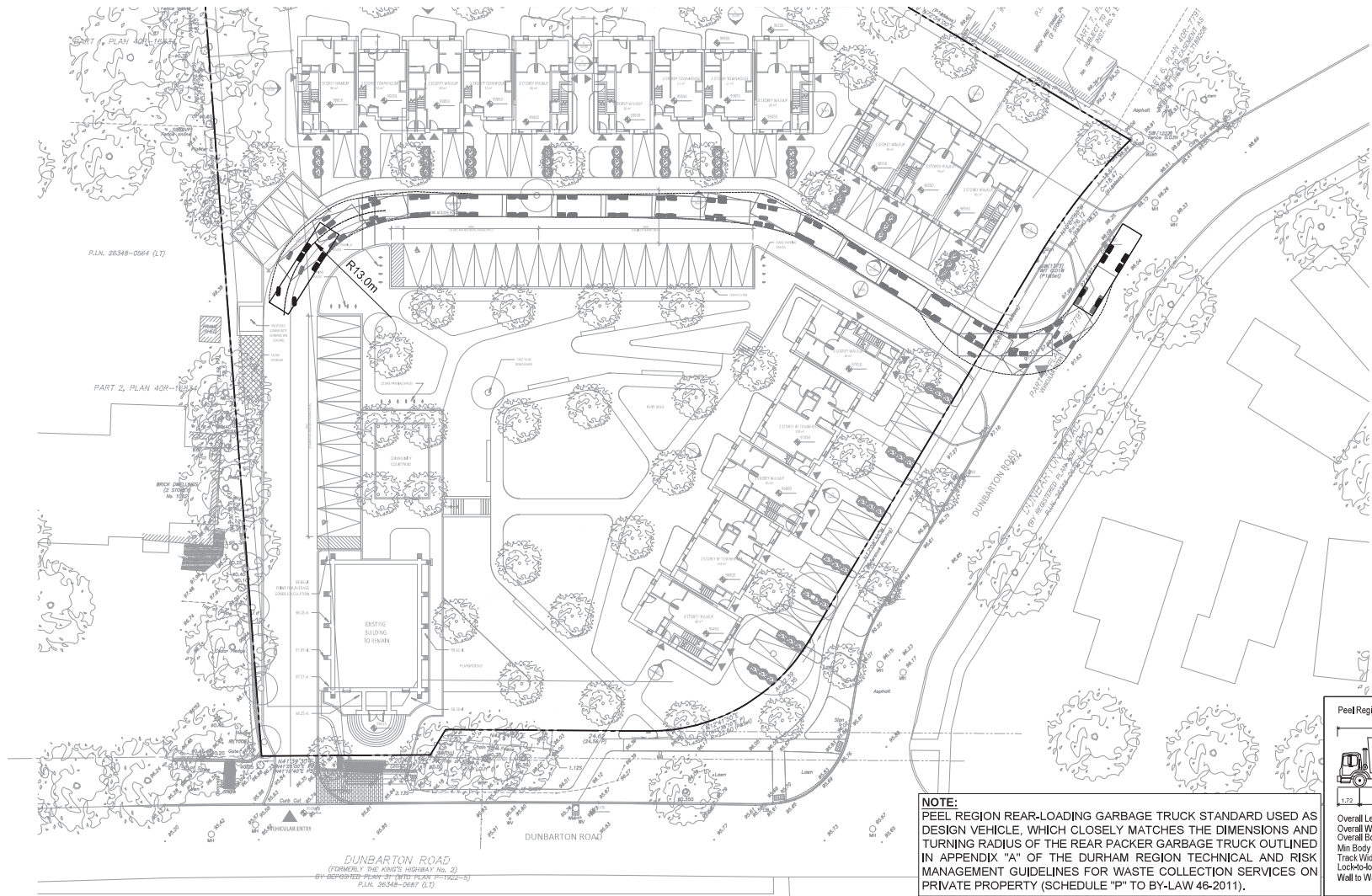

Date Plotted: October 19, 2022 Filename: J:\8126-28\BA\SPR15, October 17, 2022 [Final Coordination Set] BA - Dunbarton Fairport - VMDr - Oct17-22.dwg



**NOTE:**  
 PEEL REGION REAR-LOADING GARBAGE TRUCK STANDARD USED AS DESIGN VEHICLE, WHICH CLOSELY MATCHES THE DIMENSIONS AND TURNING RADIUS OF THE REAR PACKER GARBAGE TRUCK OUTLINED IN APPENDIX "A" OF THE DURHAM REGION TECHNICAL AND RISK MANAGEMENT GUIDELINES FOR WASTE COLLECTION SERVICES ON PRIVATE PROPERTY (SCHEDULE "P" TO BY-LAW 46-2011).

Peel Region Garbage - Rear Loader	
Overall Length	11,480mm
Overall Width	2,710mm
Overall Body Height	3,310mm
Min Body Ground Clearance	0,295m
Track Width	2,710mm
Lock-to-lock time	5,008
Wall to Wall Turning Radius	13,000mm



**1066 DUNBARTON RD  
 VEHICLE MANOEUVRING DIAGRAM  
 GARBAGE TRUCK - INBOUND**

Project: 1066 DUNBARTON RD  
 Project No. 6126-28  
 Date: OCTOBER 19, 2022  
 Revised: -

Scale: 0 5 10 15 20m  
 1:500

Drawing No. **VMD-01**

Date Plotted: October 19, 2022 Filename: J:\8126-28\BA\SPR15, October 17, 2022 [Final Coordination Set] BA - Dunbarton Fairport - VMDs - Oct17\22.dwg

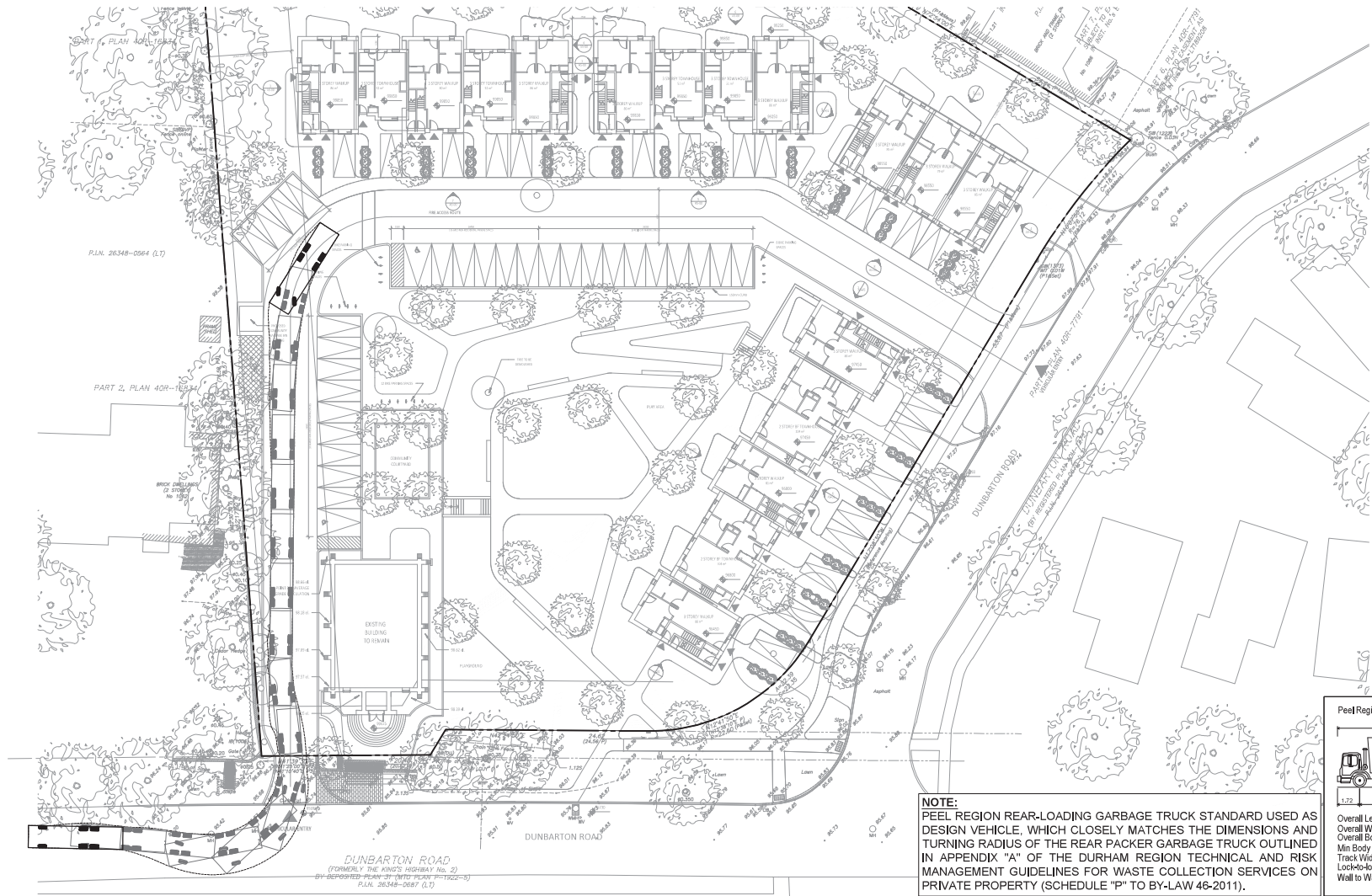

**NOTE:**  
 PEEL REGION REAR-LOADING GARBAGE TRUCK STANDARD USED AS DESIGN VEHICLE, WHICH CLOSELY MATCHES THE DIMENSIONS AND TURNING RADIUS OF THE REAR PACKER GARBAGE TRUCK OUTLINED IN APPENDIX "A" OF THE DURHAM REGION TECHNICAL AND RISK MANAGEMENT GUIDELINES FOR WASTE COLLECTION SERVICES ON PRIVATE PROPERTY (SCHEDULE "P" TO BY-LAW 46-2011).

Peel Region Garbage - Rear Loader	
Overall Length	11,480m
Overall Width	2,710m
Overall Body Height	3,910m
Min Body Ground Clearance	0,295m
Track Width	2,710m
Lock-to-lock time	5,00s
Wall to Wall Turning Radius	13,000m



**1066 DUNBARTON ROAD  
 VEHICLE MANOEUVRING DIAGRAM  
 GARBAGE TRUCK - OUTBOUND**

Project: 1066 DUNBARTON RD  
 Project No. 6126-28  
 Date: OCTOBER 19, 2022  
 Revised: -

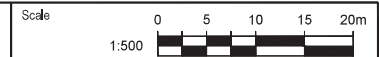

Drawing No. **VMD-02**