

**Properties subject to OPA 38, as approved by OLT-22-004770 Decision  
Sheet 1 of 4 - Rougemount Precinct Intensification Area**

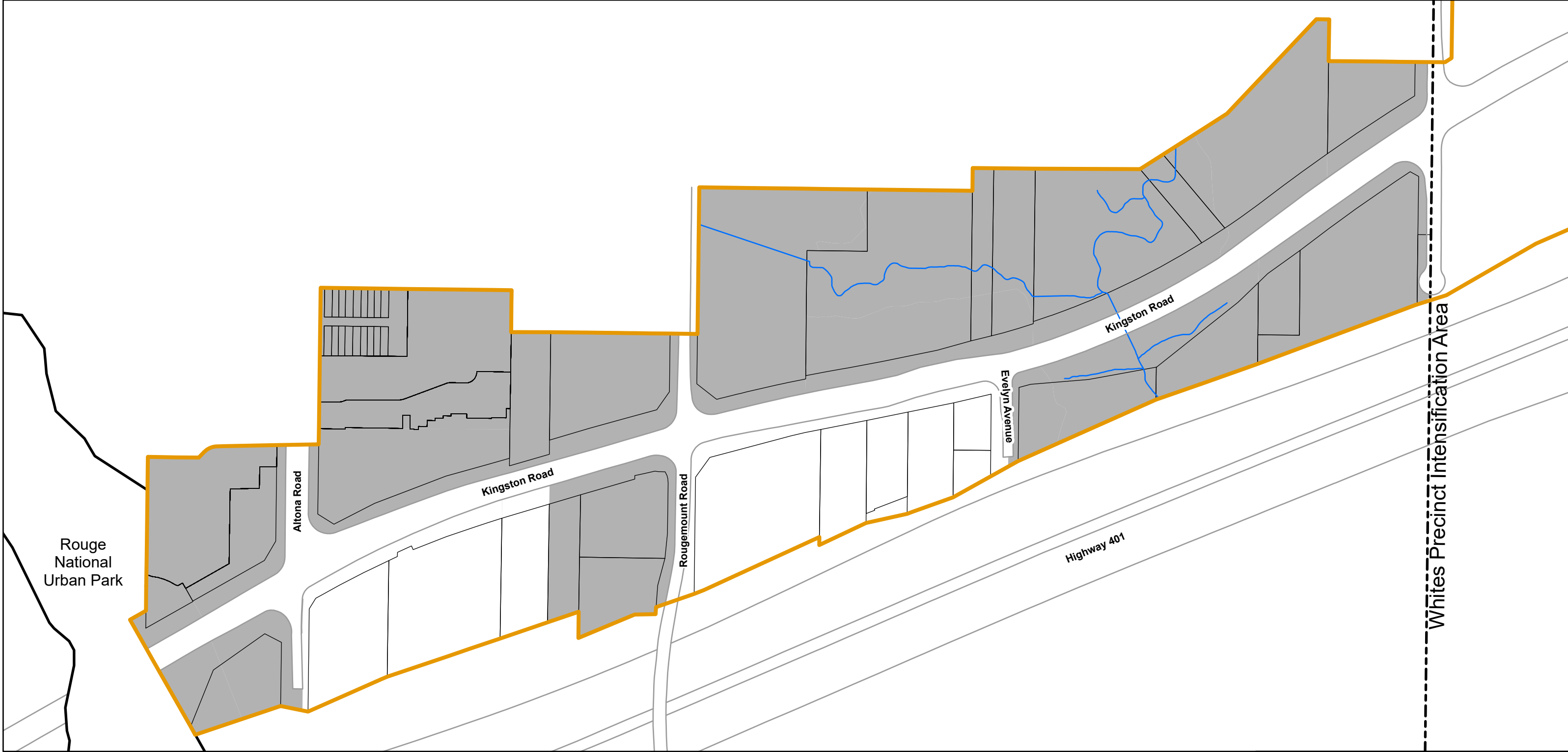

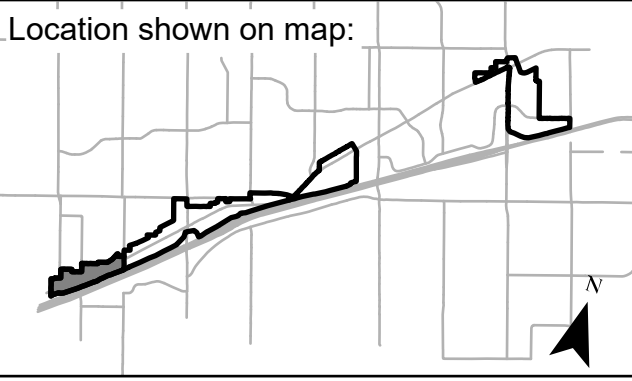

**Legend**  
 Boundary of the Kingston Road Corridor and Brock Mixed Node Intensification Area

Properties subject to OPA 38, as approved by OLT-22-004770 Decision

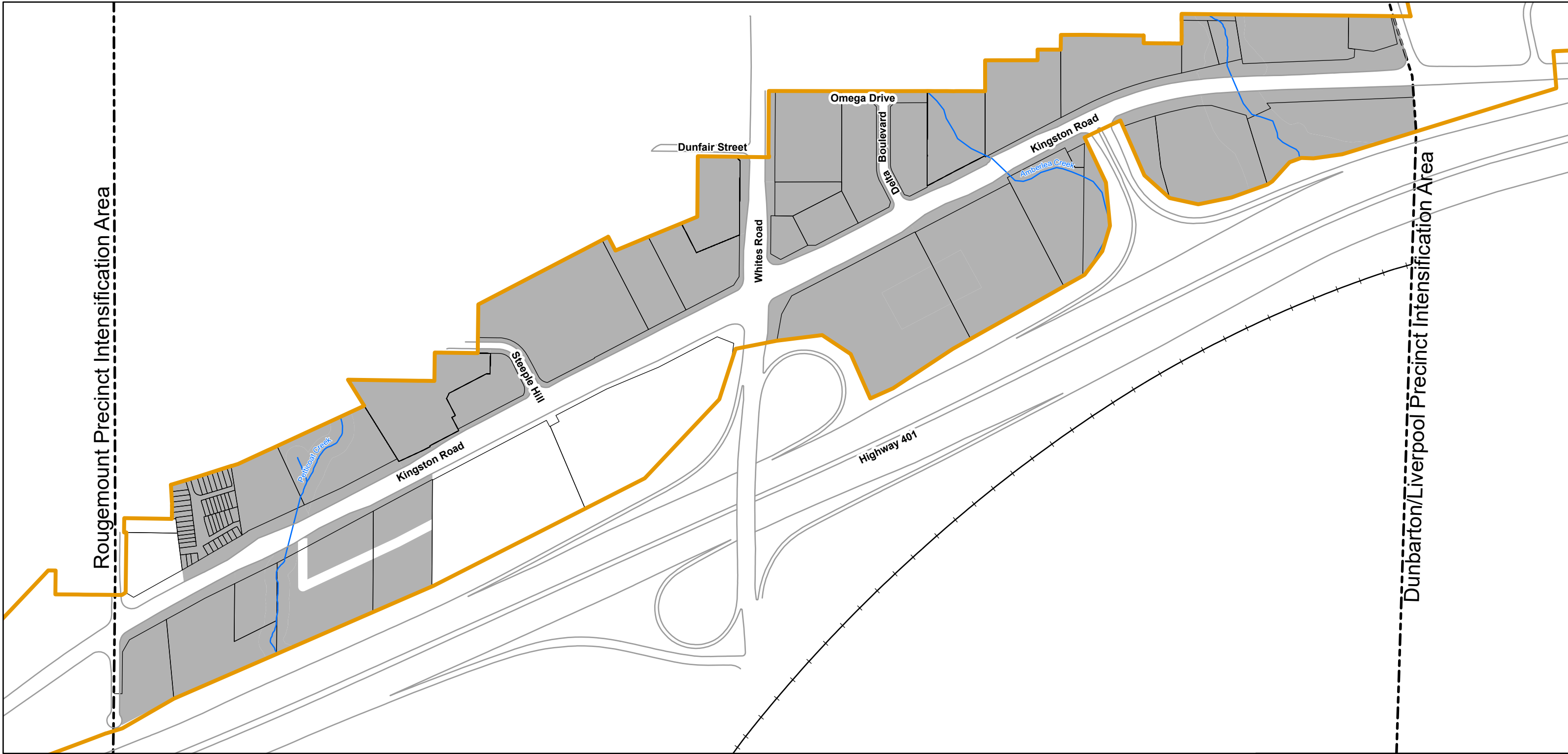

**Properties subject to OPA 38, as approved by OLT-22-004770 Decision  
Sheet 2 of 4 - Whites Precinct Intensification Area**



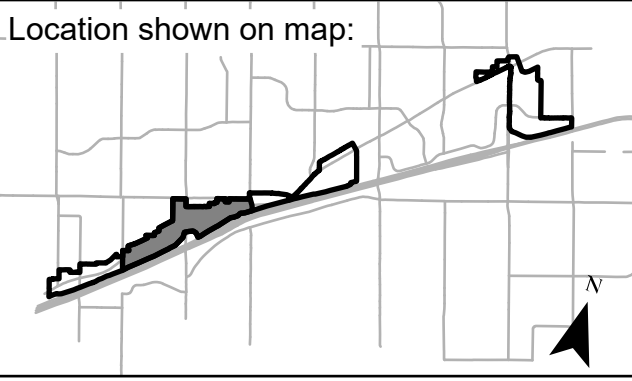

**Legend**  
 Boundary of the Kingston Road Corridor and Brock Mixed Node Intensification Area

 Properties subject to OPA 38, as approved by OLT-22-004770 Decision

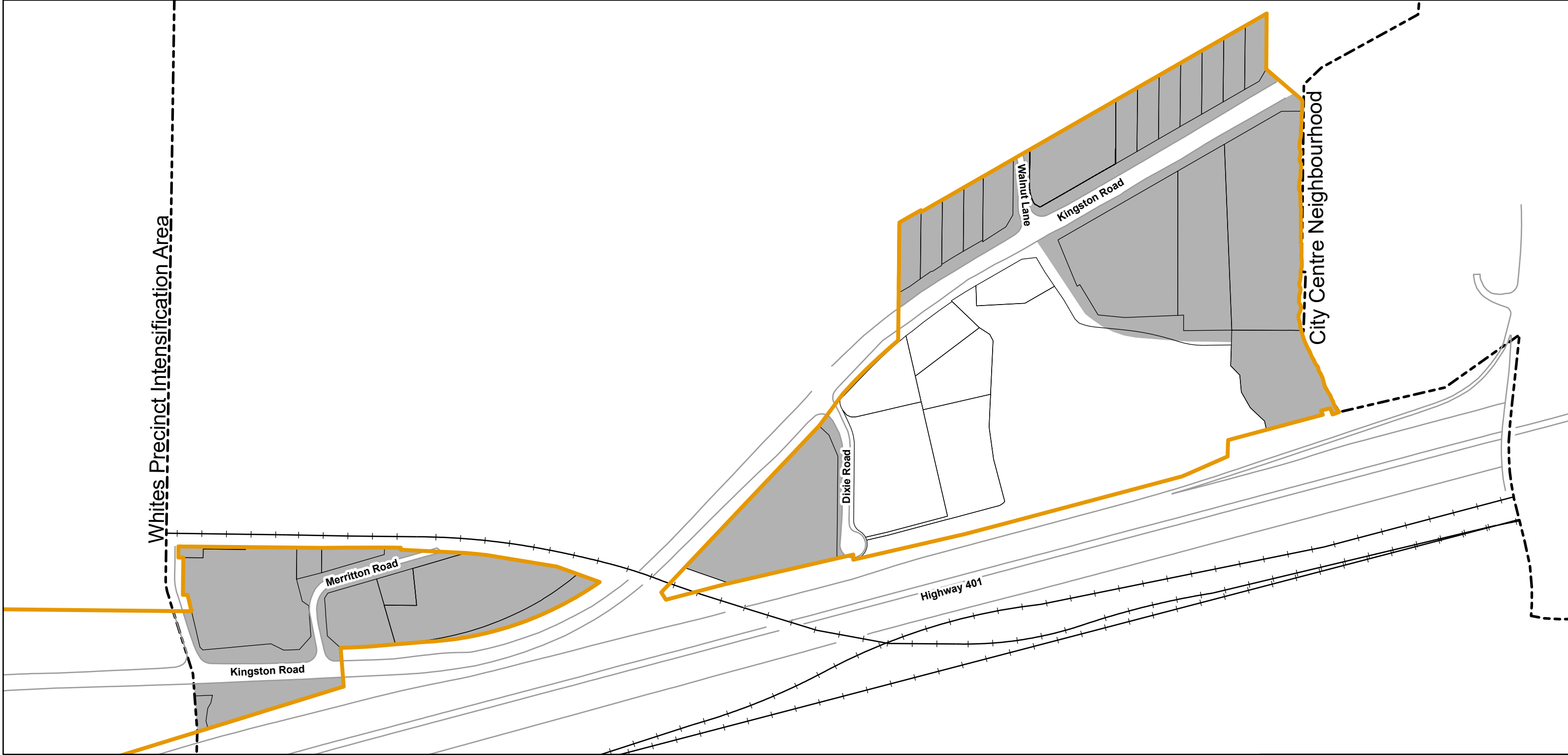

**Properties subject to OPA 38, as approved by OLT-22-004770 Decision  
Sheet 3 of 4 - Dunbarton/Liverpool Precinct Intensification Area**



**Legend**  
 Boundary of the Kingston Road Corridor and Brock Mixed Node Intensification Area

 Properties subject to OPA 38, as approved by OLT-22-004770 Decision

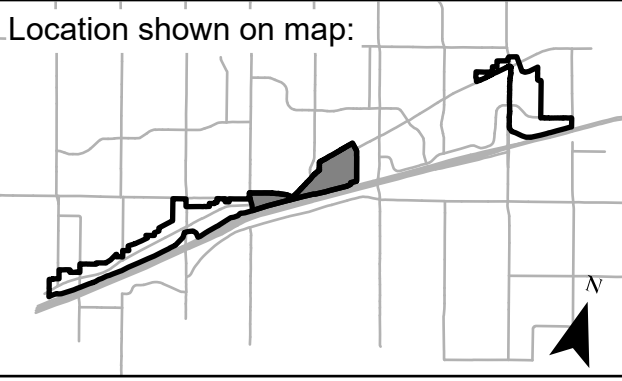

**Properties subject to OPA 38, as approved by OLT-22-004770 Decision  
Sheet 4 of 4 - Brock Precinct Intensification Area**

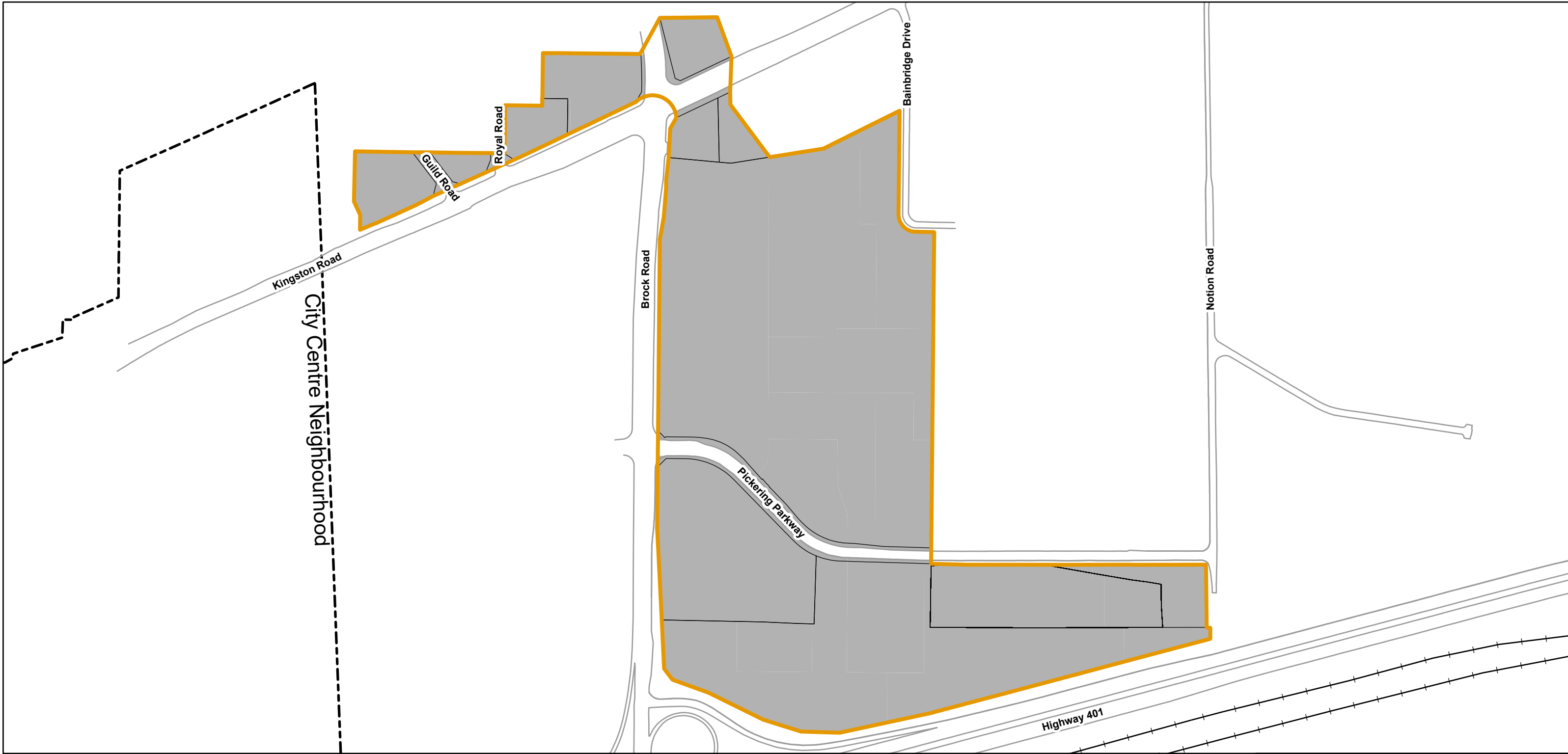

**Legend**  
 Boundary of the Kingston Road Corridor and Brock Mixed Node Intensification Area

Properties subject to OPA 38, as approved by OLT-22-004770 Decision

