

CONSTRUCTION MANAGEMENT NOTES:

1. ALL OF THE CONTRACTOR'S OPERATIONS AND ACTIVITIES SHALL BE IN ACCORDANCE WITH THE MOST CURRENT VERSION OF THE ONTARIO TRAFFIC MANUAL (OTM) FOR TEMPORARY CONDITIONS - BOOK 7, MTO MANUAL OF UNIFORM TRAFFIC CONTROL DEVICES AND AS PER THE OCCUPATIONAL HEALTH AND SAFETY ACT.
2. ALL CONSTRUCTION EQUIPMENT TO BE PARKED ON-SITE THROUGHOUT THE ENTIRE DURATION OF CONSTRUCTION.
3. HOURS OF OPERATION (INCLUDING ANY DELIVERY OF MATERIAL AND EQUIPMENT) SHALL BE AS PER TOWN OF AJAX NOISE BY-LAWS.
4. THE CONTRACTOR SHALL BE REQUIRED TO PREVENT DUST NUISANCE RESULTING FROM CONTRACTOR OPERATIONS. WHERE THE WORK WILL RESULT IN THE CREATION OF SUFFICIENT DUST TO IMPACT ADJACENT LANDOWNERS, ROADWAYS OR THE GENERAL PUBLIC, THE CONTRACTOR WILL BE RESPONSIBLE TO ENSURE DUST CONTROL MEASURES ARE IMPLEMENTED. THE COST OF ALL SUCH DUST CONTROL PREVENTATIVE MEASURES SHALL BE BORNE BY THE CONTRACTOR, INCLUDING THE PLACEMENT OF WATER OR CALCIUM CHLORIDE AS DIRECTED BY THE CONTRACT ADMINISTRATOR OR THE CITY OF PICKERING.
5. THE CONTRACTOR SHALL BE RESPONSIBLE FOR ALL DIRT AND MUD THAT IS TRACKED ONTO THE ROADWAYS FROM VEHICLES ENTERING OR LEAVING THE SITE. THE CONTRACTOR SHALL, UPON REQUEST FROM THE CONTRACT ADMINISTRATOR, IMMEDIATELY PROCEED WITH A CLEAN-UP OPERATION AT HIS EXPENSE.
6. FOR STORMWATER RUN-OFF CONTROLS, DETAILS PERTAINING TO SILT FENCE, SEDIMENT BASIN AND MUD MAT, REFER TO THE EROSION & SEDIMENT CONTROL PLANS.
7. TEMPORARY LANE CLOSURES AND ENCROACHMENTS TRAFFIC CONTROL AND SIGNAGE DURING CONSTRUCTION, PERMANENT SIGNS AND LANE MARKINGS SHALL BE IN ACCORDANCE WITH THE MOST CURRENT VERSION OF THE ONTARIO TRAFFIC MANUAL (OTM) FOR TEMPORARY CONDITIONS - BOOK 7 AND THE MTO MANUAL OF UNIFORM TRAFFIC CONTROL DEVICES.
8. ALL PROPOSED TRAFFIC CONTROL DEVICES AND SIGNAGE MUST BE MAINTAINED IN THEIR PROPER LOCATION, CLEANED, WEIGHTED DOWN BY SANDBAGS ONLY AND MAINTAINED THROUGHOUT THE DURATION OF THE WORK.
9. ALL 'TRAFFIC CONTROL PERSONS' SHALL BE AS DEFINED IN BOOK 7 OF THE OTM AND ARE NOT PERMITTED TO DIRECT TRAFFIC WITHIN AN INTERSECTION WITH A TRAFFIC SIGNAL.
10. TRAFFIC CONTROL PERSONS ARE TO BE UTILIZED TO ASSIST WITH VEHICLE INGRESS / EGRESS. ONE TRAFFIC CONTROL PERSON PER TRAFFIC LANE SHALL BE UTILIZED.
11. NO LANE CLOSURES ARE PERMITTED ON WEEKDAYS BETWEEN THE HOURS OF 7:00 A.M. TO 9:30 A.M. AND 3:30 P.M. TO 6:00 P.M. THE CONTRACTOR MUST BE AWARE OF HEAVY TRAFFIC VOLUMES DURING THE MORNING AND EVENING RUSH HOURS. UNLESS OTHERWISE NOTED, WORK MUST BE SCHEDULED RESPECTING TRAFFIC FLOWS, TAKING PLACE BETWEEN 9:30AM AND 3:30PM ON WEEK-DAYS.
12. THE CONTRACTOR SHALL PROVIDE TO THE CITY, A 24-HOUR CONTACT, WHICH MUST BE MADE AVAILABLE THROUGHOUT THE DURATION OF THE PROJECT.
13. THE CONTRACTOR SHALL BE RESPONSIBLE FOR OBTAINING ALL NECESSARY APPROVALS IN ADVANCE OF COMMENCING WORK AS DETERMINED BY THE CITY (I.E. ROAD OCCUPANCY PERMIT ETC.).

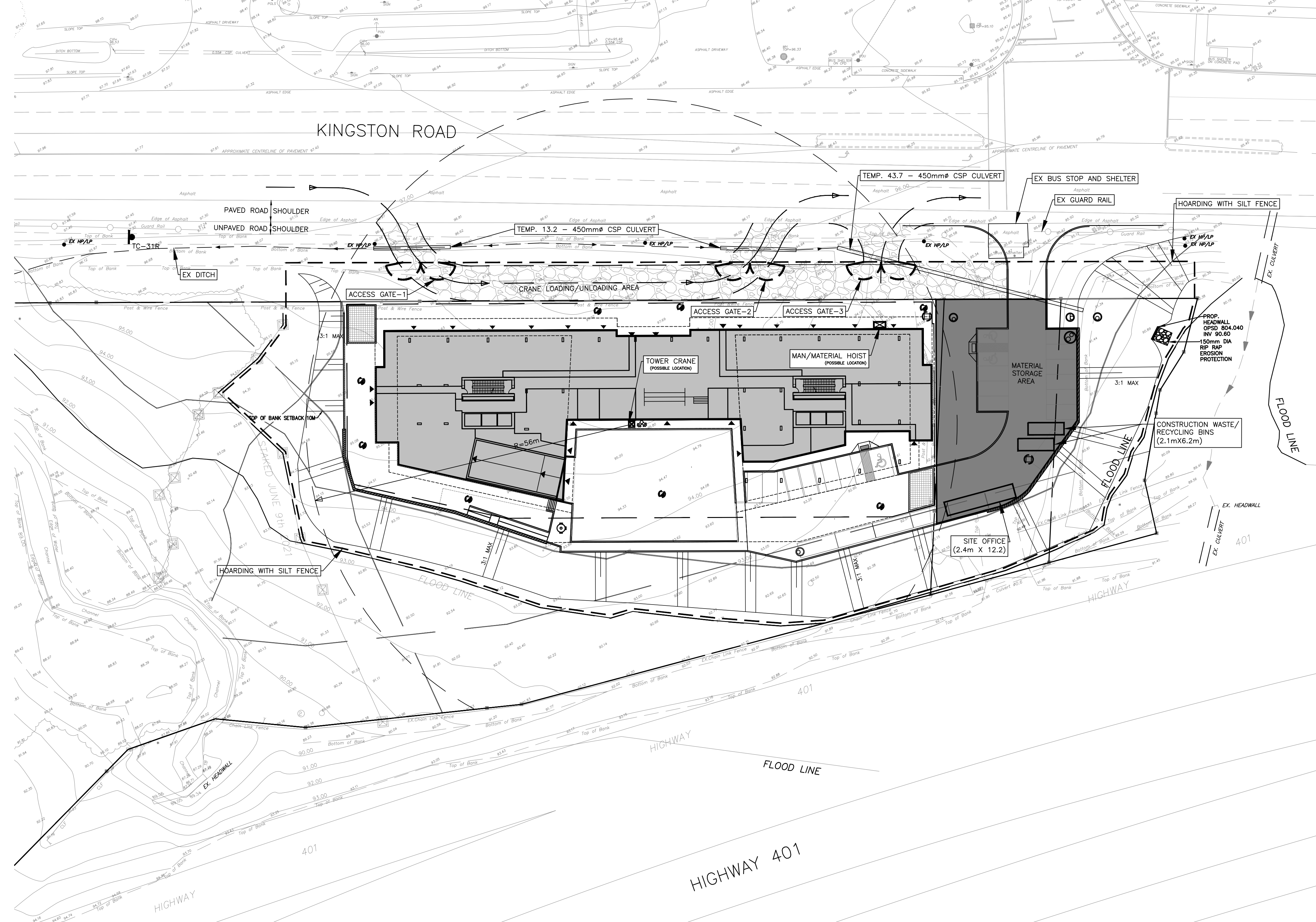
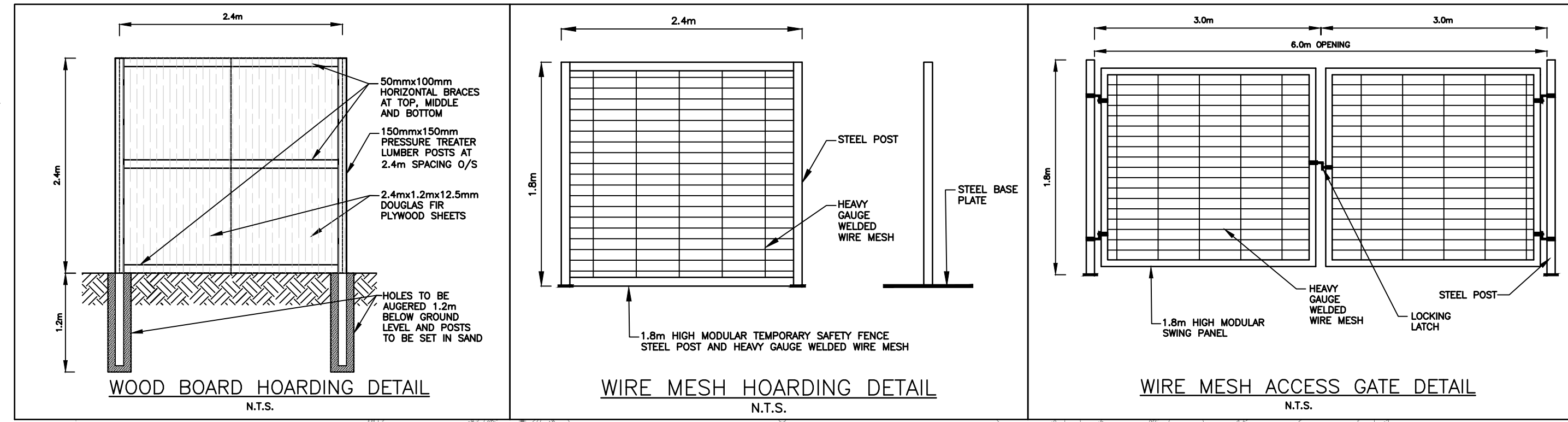

CONSTRUCTION SITE SIGNAGE

ENTRANCE SIGNS

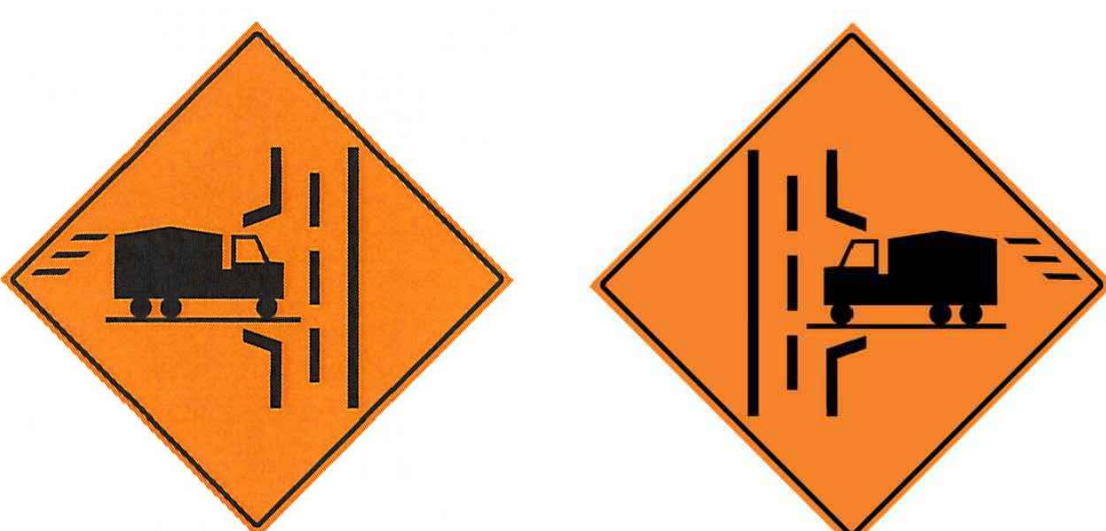

EXIT SIGNS



TRAFFIC CONTROL SIGNAGE - STOPPING TRAFFIC



NOTE
THIS PLAN HAS BEEN PREPARED TO DEMONSTRATE FEASIBILITY OF THE PROPOSED DEVELOPMENT WITH RESPECT TO CONSTRUCTION MANAGEMENT IN CONJUNCTION WITH THE, ZONING BY-LAW AMENDMENT, APPLICATIONS. DETAILED CONSTRUCTION MANAGEMENT PLAN WILL BE PREPARED AT THE SITE PLAN APPLICATION STAGE

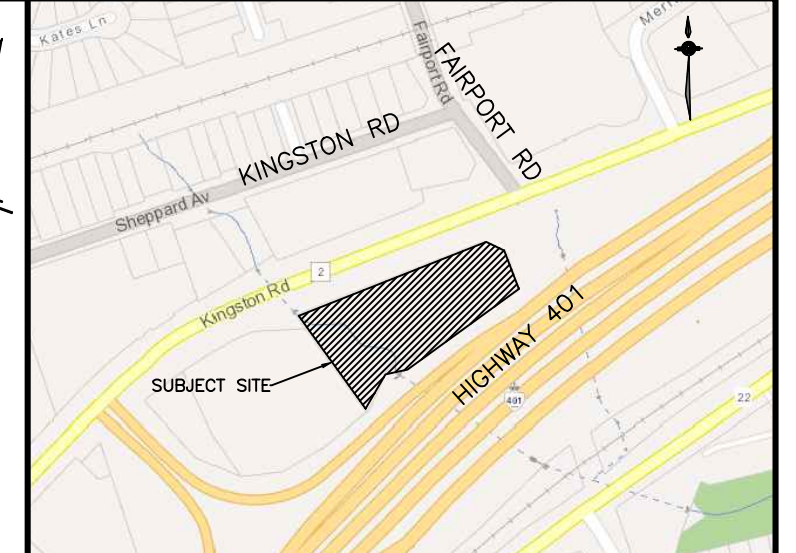

LEGEND:

- HOARDING FACILITY
- CONSTRUCTION TRAFFIC
- AREA DRAIN
- CATCHBASIN
- RETAINING WALL
- EXTERIOR DOOR LOCATION
- SEDIMENT CONTROL FENCE
- SEDIMENT TRAP
- HYDRO TRANSFORMER

BENCHMARK NOTE:
ELEVATIONS SHOWN HEREON ARE GEODETIC AND ARE REFERRED. BENCHMARK No.0011967U039 HAVING AN ELEVATION OF 95.152 METERS LOCATED IN MANHOLE ON WEST SIDE OF CHURCH STREET, 0.3 KILOMETERS SOUTH OF HIGHWAY No.2, 11.6 METERS EAST OF NORTHEAST CORNER OF ST. FRANCIS DE SALES SCHOOL, 10.4 METERS WEST OF CENTRE LINE OF ROAD, 4.0 METERS SOUTH OF WIRE FENCE, 5.5 METERS SOUTHWEST OF POWER POLE NO.53.

BEARING NOTE:
BEARINGS SHOWN ARE GRID BEARINGS AND DERIVED FROM OBSERVED REFERENCE POINTS (ORP'S) 1 AND 2 BY REAL TIME NETWORK OBSERVATIONS, UTM ZONE 17, NAD 83 (CSRS) (1997.0 EPOCH). DISTANCES SHOWN ON THIS PLAN ARE GROUND DISTANCES AND CAN BE CONVERTED TO GRID DISTANCES BY MULTIPLYING BY THE COMBINED SCALE FACTOR OF 0.99987

METRIC:
DISTANCES SHOWN ON THIS PLAN ARE IN METERS AND CAN BE CONVERTED TO FEET BY DIVIDING BY 0.3048

| NO. | DATE | REVISIONS | BY |
|-----|------|-----------|----|
| | | | |
| | | | |
| | | | |

VALDOR ENGINEERING INC.
Consulting Engineers - Project Managers
571 Chesson Road, Unit 4, 2nd Floor, Woodbridge, Ontario L4L 0A9
Tel: (905) 884-6084, Fax: (905) 884-0690
E-Mail: info@valdor-engineering.com
www.valdor-engineering.com

PROFESSIONAL ENGINEER
D. A. GIUGOZZI
MAY 12, 2023
PROVINCE OF ONTARIO

PROPOSED RESIDENTIAL DEVELOPMENT
875 KINGSTON ROAD
CITY OF PICKERING

CONSTRUCTION MANAGEMENT PLAN

| | | |
|------------------|-----------------------------|----------------------|
| SCALE 1:400 | DATE OF DWG. MAY 12/2023 | PROJECT NO. 22115 |
| DRAWN BY P.M. | DRAWING NO. CMP-1 | |
| CHKD BY D.G. | | |